

# Robert Young – 540 acres in Greenbrier County

## History

Warrant number 12227 issued  
 Warrant number 14000 issued  
 November 29, 1793 Date of Survey  
 February 19, 1796 Patented by Robert Brooke, Esq.,  
 Governor of Virginia

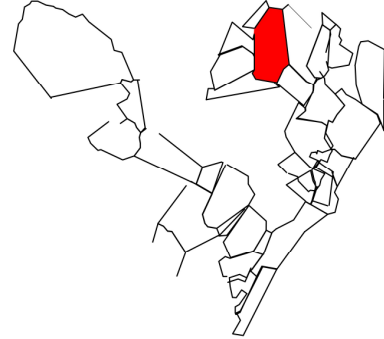

## Description

540 acres in Greenbrier County on waters of Sinking Creek joining the land of Jacob Chapman and a survey made for said Young of 425 acres

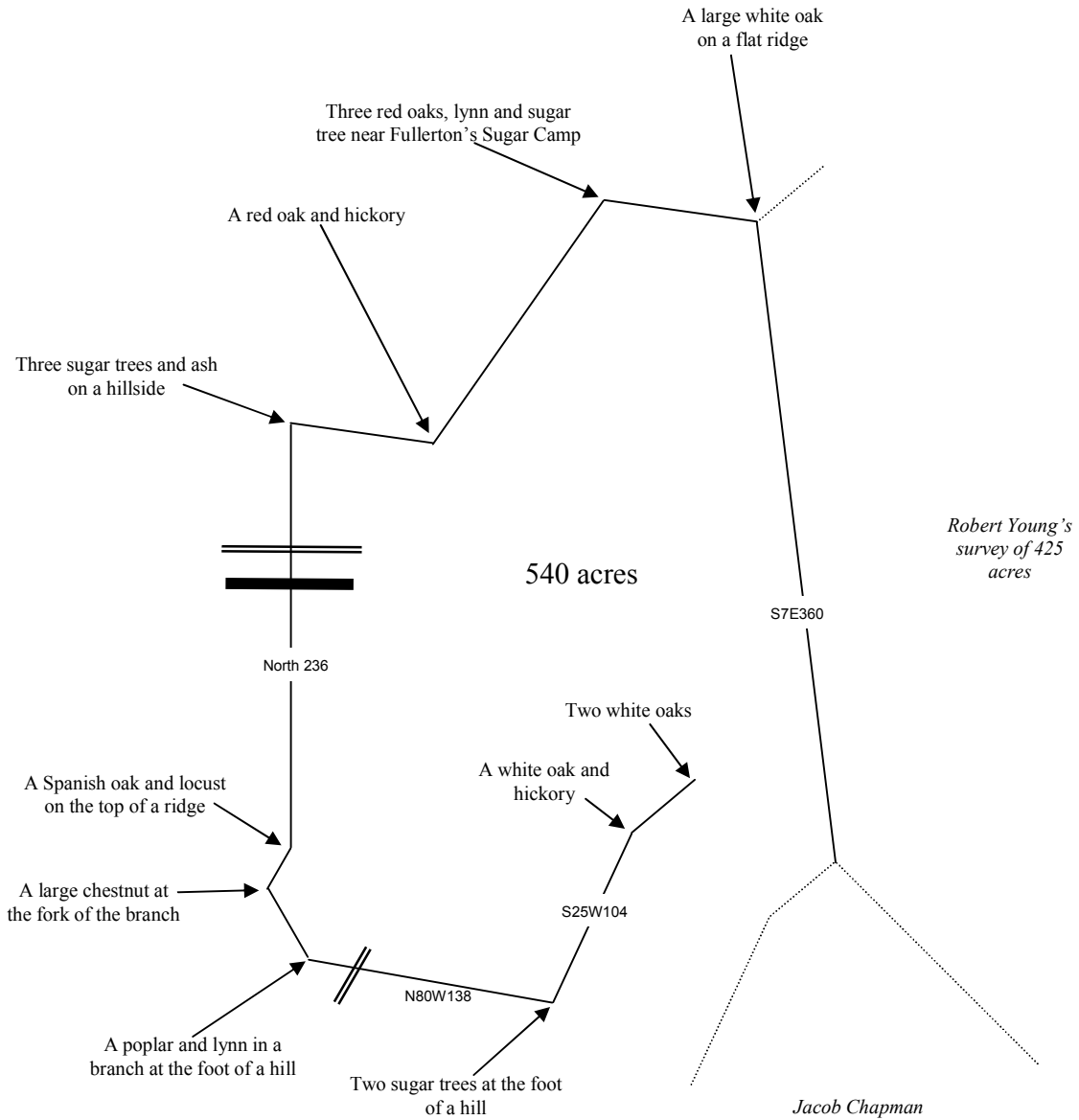

9  
Rob<sup>t</sup> Young  
510 Acres  
Greensboro  
&  
v

Robert Brooke esquire Governor of the Commonwealth of Virginia  
To all To whom these presents shall come Greeting: Know ye, that  
by virtue of two Land Office Treasury Warrants Numbers twelve  
thousand two hundred and twenty seven, and fourteen thousand  
there is granted by the said Commonwealth unto Robert Young  
a certain tract or parcel of Land containing five hundred and forty  
Acres, by survey bearing date the twenty ninth day of November  
One thousand seven hundred and ninety three, lying and being in  
the County of Greensboro, on waters of Sinkin Creek joining the Lands  
of Jacob Chapman and a survey made for said Young of four  
hundred and twenty five Acres, and is bounded as followeth to wit,  
Beginning at two white Oaks corner to his survey of four hundred  
and twenty five Acres and corner to Chapman, and with the latter  
South fifty degrees West forty six poles to a white Oak and hickory,  
South twenty five degrees West one hundred and four poles to two  
sugar trees at the foot of a hill; and leaving Chapman North eighty  
degrees West one hundred and thirty eight poles crossing a branch to  
a Poplar and Sycam <sup>at the</sup> foot a hill, North thirty degrees West  
forty four poles to a large Chesnut at the fork of said branch, North  
thirty degrees East twenty six poles to a Spanish Oak and Locust on  
the top of a ridge, North two hundred and thirty six poles  
crossing a road and Chapman's branch to three Sugar trees &  
ash on a hill side, South eighty two degrees East eighty poles to a red  
Oak and Hickory, North thirty five degrees East one hundred and  
sixty six poles to three red Oaks Sycam and Sugar tree near Fullertons  
sugar Camp, South eighty two degrees East eighty six poles to a large  
white Oak on a flat ridge, corner to said Youngs survey of four  
hundred and twenty five Acres and running with the same, South  
seven degrees East three hundred and sixty poles to two white  
Oaks Chappmans corner to the Beginning, with its appurtenances  
to the said Robert Young and his Heirs for ever. In Witness  
whereof the said Robert Brooke esquire Governor of the  
Commonwealth of Virginia hath hereunto set his hand and caused

the

the Great Seal of the said Commonwealth, to be affixed at Richmond on the nineteenth day of February in the year of our Lords One thousand seven hundred and ninety six, and of the Commonwealth the twentieth

Robert Brooke

William King  
20,280 Acres  
Lee County  
Car.

Robert Brooke Esquire, Governour of the Commonwealth of Virginia  
To all to whom these presents shall come Greeting: Know ye that by virtue of two Land Office Treasury Warrants Numbers eleven hundred and seventy, and eleven hundred and seventy five: There is granted by the said Commonwealth unto William King, a certain Tract or parcel of Land containing twenty thousand two hundred and Eighty Acres, by Survey bearing date the twenty ninth day of April One thousand seven hundred and ninety five, lying and being in the County of Lee, on the waters of Powells River, and is bounded as followeth, to wit: Beginning at three White Oaks and a dogwood tree Miles East of Indian Creek, where the State line crosseth, and running North sixty degrees East six hundred & forty six poles crossing three branches to a poplar marked W. C. six maples and a White Oak on a flat, nigh the meadow branch North Eighty degrees East three hundred and twenty poles to three White Oaks on the East side of Cottrells branch, North thirty degrees East six hundred and seventy six poles to a large stooping White Oak and a Chesnut on the side of a ridge, North eighty degrees East three hundred and Eighty poles to three Chesnut Oaks and two dogwood saplings on a ridge, North seventy degrees East two hundred and twenty eight poles to four Chesnut Oaks a Chesnut & two dogwood saplings on a rise, North sixty degrees East five hundred and sixty poles to four Poplars on a rise, North seventy degrees East two hundred and thirty four poles to two white Oaks a black Oak and two dogwood saplings on a rise, North sixty degrees East four hundred and twenty poles, to a Chesnut a White Oak and double Poplar on a ridge, North fifty degrees East seventy six poles to two Spanish Oaks, a black Oak, a poplar and dogwood sapling on a rise, North

forty