

# John Huggins – 280 acres in Greenbrier County

## History

January 24, 1783 Warrant number 158 issued  
 April 20, 1796 Date of Survey  
 January 21, 1800 Patented by James Monroe,  
 Governor of Virginia

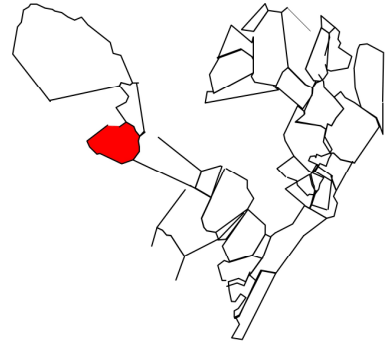

## Description

280 acres in Greenbrier County on the head branches  
 of Laurel Run a branch of Little Clear Creek joining the  
 lands of William Jordan and Henry Banks

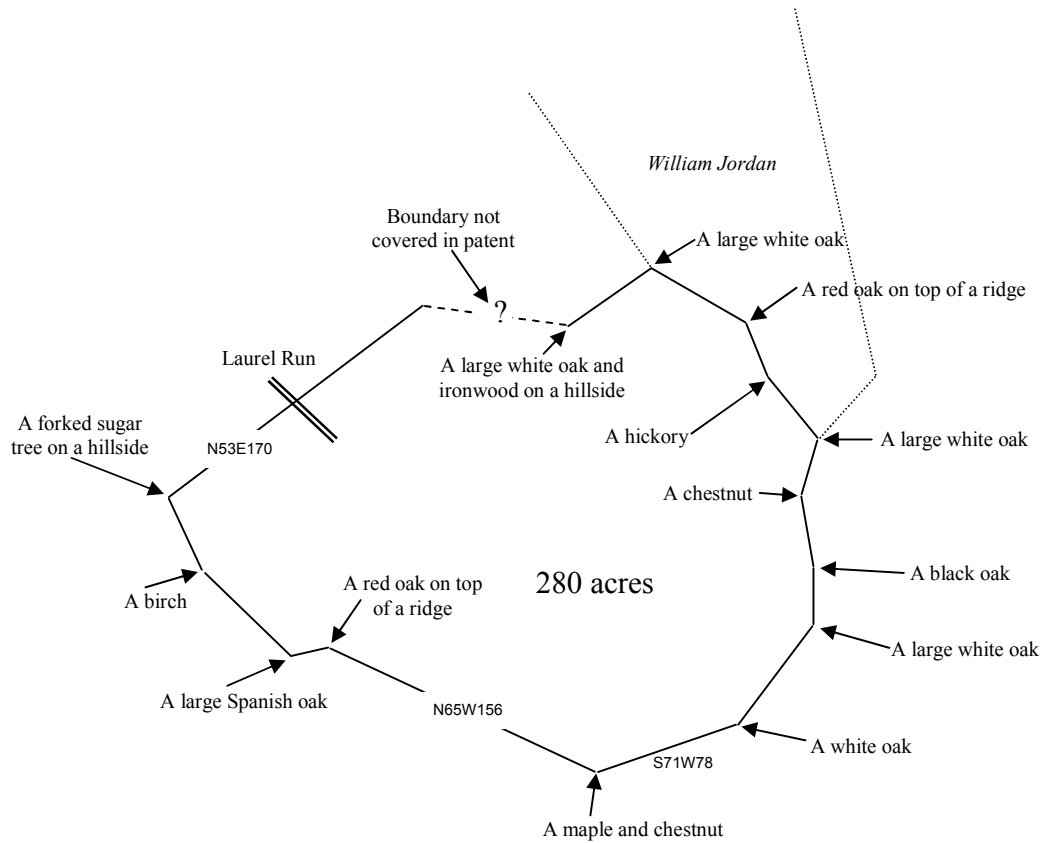

|-----|  
 1 inch = 100 poles  
 (1650 feet)

James Monroe Esquire Governor of the Commonwealth of Virginia to all to whom

John Huggins  
780<sup>2</sup> Acres  
Greenbrier  
Co. Va

these presents shall Com. Greeting: Know ye that by virtue of an Exchanged Land office  
Treasury Warrant Number One Hundred fifty Eight issued the Twenty fourth day of  
January Seventeen Hundred and Eighty three there is Granted by the said Com-  
monwealth unto John Huggins Assignee of James and David M. Coy who were  
Assignees of Stephen Banks a certain Tract or parcel of Land, containing Two Thousand  
and Eighty Acres by Survey bearing date the Twentieth day of April One thousand  
Seven Hundred and Ninety six lying and being in the County of Greenbrier on the  
head Branches of Seconel Run a branch of Little Clear Creek Joining the lands of  
William Jordan and Henry Banks and bounded as followeth to wit, Beginning  
at a large white oak and Ironwood on a hill side and Running North Fifty five  
Degrees East Fifty four poles to a large white oak corner to Jordan and with  
his lines South Sixty degrees East Fifty eight poles to a red oak top a ridge South  
Twenty two Degrees East thirty poles to a hickory South thirty nine Degrees East forty  
two poles to a large white oak corner to Jordan and leaving South sixteen Degrees  
West thirty poles to a Chesnut South Ten Degrees East thirty eight poles to a  
black oak and South thirty poles to a large white oak South thirty seven  
Degrees West sixty six poles to a white oak South seventy one Degrees West  
seventy eight poles to a maple and Chesnut North sixty five Degrees West One  
Hundred and fifty six poles to a red oak on top a ridge South seventy  
seven Degrees West twenty poles to a large Spanish Oak North forty six  
Degrees West sixty four poles to a Birch North twenty five Degrees West forty two  
poles to a forked Sugar tree on a hill side North fifty three Degrees East One  
Hundred and seventy poles Cross Waters of Seconel Run to a large white oak  
the Beginning with its appurtenances to have and to hold the said Tract or parcel  
of Land with its appurtenances to the said John Huggins In Witness whereof the said  
James Monroe Esquire Governor of the Commonwealth of Virginia hath hereunto set  
his hand and caused the lesser Seal of the said Commonwealth to be affixed at

Richmond

29.

Richmond on the Twenty first day of January in the year of our Lord One Thousand Eight Hundred and of the Commonwealth the Twentyfourth

James Monroe

Philip Nances

Benj<sup>n</sup> Sharp

1713's acres

Lee County

Wm. Del.

James Monroe Esquire Governor of the Commonwealth of Virginia to all

to whom these presents shall come. Knowing that by Virtue of three said

Office Treasury Warrants to wit Four Hundred and fifteen Acres by Number

one thousand two hundred and fifty, Two hundred and Ninety eight and

one half acres by Number fourteen thousand one hundred & eighty seven and

two hundred acres the residue by Number nine thousand & forty three is

granted by the said Commonwealth unto Philip Nances and Benjamin

Sharp. said Sharp is assignee of said Nances for a Morley thereof a

certain tract or parcel of Land containing more hundred thirty and a half

acres by survey bearing date the twenty second day of October one

thousand seven hundred and ninety eight lying and being in the County of

Lee and bounded as followeth to wit Beginning at a poplar and two

Spanish Oaks North fifty degrees east fifty six poles to a large poplar near the

top of a hill North one hundred and four poles crossing four mile creek thence

to a black oak Spanish Oak and buck eye on the bank of said Creek North thirty

degrees east eighty six poles crossing said creek to two white Oaks a corner

of James Coulthart and with his line passing through salt lick North

fifty seven degrees west sixty three poles to a large poplar North eighty

seven degrees west eighty poles to a Chestnut thence leaving said line

South seventy four degrees west one hundred and fifty poles to a white Oak &

poplar in the head of a hollow North thirty five degrees west one hundred

poles to a white Oak and Poplar on the south side of a ridge North sixty

two degrees west seventy poles to a large black Oak (and poplar in a hollow

South forty five degrees west eighty four poles to a large Chestnut on

the side of a ridge South seventy degrees west three hundred poles to a

hickory