

# Thomas Blake, assignee of George Blake – 137 acres in Greenbrier County

## History

By virtue of a certificate in right of settlement given by the commissioners for adjusting the titles to unpatented lands in the District of Augusta, Botetourt and Greenbrier and in consideration of the ancient composition of 15 shillings sterling  
 Part of a land office treasury warrant number 10326  
 March 8, 1787 Date of Survey  
 March 17, 1789 Patent signed by Beverley Randolph, Esq., Governor of Virginia Examined

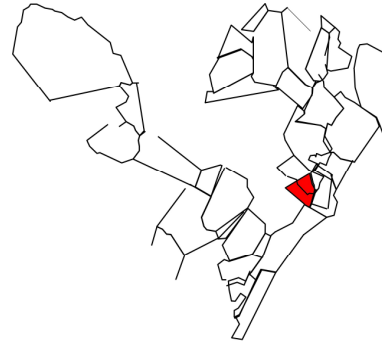

## Description

137 acres in Greenbrier County joining the lands of William H. Cavendish, Michael Ocheltree, and Francis Ford on Sinking Creek including surveys made in the year 1769

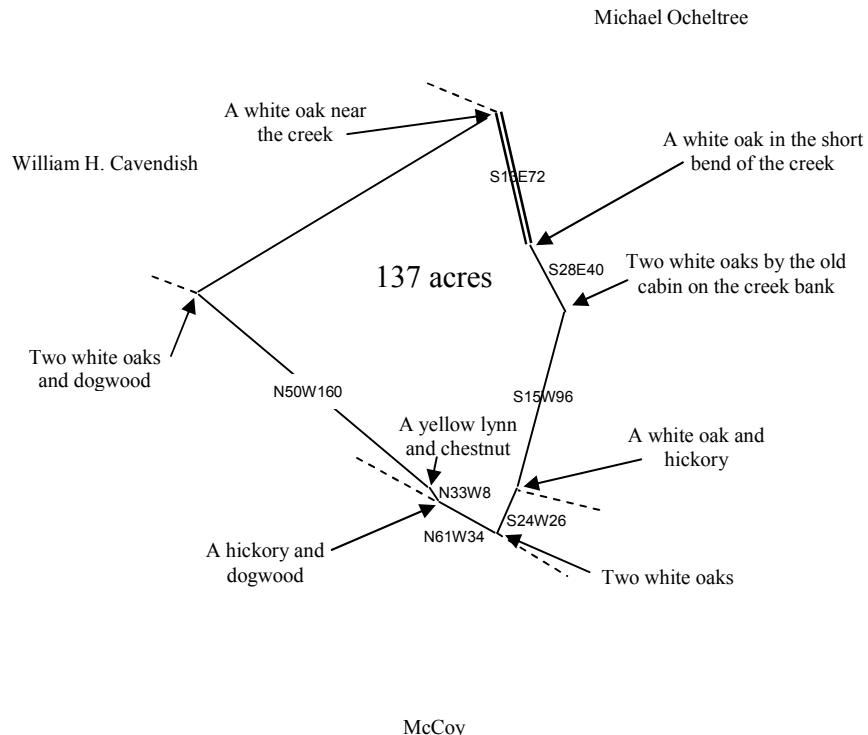

Thomas Blake  
137 Acres  
Greenbrier

Deverley Randolph Esquire Governor of the Commonwealth of Virginia, to all to whom these presents shall come, Greeting, Knowye that by virtue of a certificate in right of Settlement given by the Commissioners for adjusting the Titles to unpatented Lands in the district of Augusta, Botetourt and Greenbrier and in consideration of the ancient composition of fifteen shillings Sterling paid by Thomas Blake into the Treasury of this Commonwealth, as well as by virtue of part of an Office Treasury Warrant, Number, ten thousand, three hundred and twenty six, there is granted by the said Commonwealth unto the said Thomas Blake as Assignee of George Blake a certain tract or parcel of Land (containing) one hundred and thirty seven acres by Survey bearing date the eighth day of March one thousand seven hundred and eighty seven, Lying & being in the County of Greenbrier joining the lands of William H. Cavendish as Michael Ockletree and Francis Ford on Linking Creek including a Survey made in the year 1769 and bounded as followeth, To wit (Beginning) at a white oak near the creek corner to Cavendish and Ockletree and with the latter down the Creek South thirteen degrees East seventy two poles to a white oak in the short bend of the Creek South twenty eight degrees East forty poles crossing the Creek to two white oaks by the Old babbin and on the Creek Bank thence South fifteen degrees <sup>(Ninety six poles)</sup> West to a white oak and Hickory and leaving Ockletree's line South twenty four degrees West twenty six poles to two white oaks on all ways line and with North Sixty one degrees West thirty four poles to a Hickory and Dogwood and leaving said line North thirty three degrees West

Eight poles to a Yellow Lynn and Chestnut corner to said old Survey and with  
 North fifty degrees West one hundred and sixty poles to two white oaks and dogwood  
 corner to barndish and with his line North fifty nine degrees East one hundred  
 and eighty poles to the Beginning, with its appurtenances to have and to hold the  
 said tract or parcel of Land, with its appurtenances to the said Thomas Blake &  
 his Heirs for ever In witness whereof the said Beverley Randolph Esquire Govern-  
 nor of the Commonwealth of Virginia, hath hereunto set his hand and caused the  
 Great Seal of the said Commonwealth to be affixed at Richmond on the  
 Seventeenth day of March in the year of our Lord one thousand Seven hundred  
 and eighty nine and of the Commonwealth the thirtieth

B. Randolph

Charles Burke Beverley Randolph Esquire Governor of the Commonwealth of Virginia,  
 4 Acres  
 Amherst  
 G.<sup>d</sup>  
 to all to whom these presents shall come Greeting Know ye that An Conside-  
 ration of the Ancient Composition of five Shillings Sterling paid by Charles  
 Burke unto the Treasury of this Commonwealth, There is granted by the said Common-  
 wealth unto the said Charles Burke, a certain tract or parcel of Land contain-  
 ing four Acres by Survey bearing date the Seventeenth day of December one  
 thousand Seven hundred and eighty seven, Lying and being in the County of  
 Amherst, a small Island in the Fluvanna river, just above the mouth  
 of Laurances Creek and near the North shore and Bounded as followeth  
 To wit Beginning at the lower point of said Island and running up the  
 South side seventy one poles to the upper point, thence down the North side  
 Seventy one poles to the first Station, With its appurtenances to have & to